

DTS 609

Kalote za trapezni i sinusoidni lim sa maticom M 10

AL

- za montažu solarnih sistema na industrijskim krovovima

- vijak za spajanje kalota na lim DTS 500 ili DTS 500 S

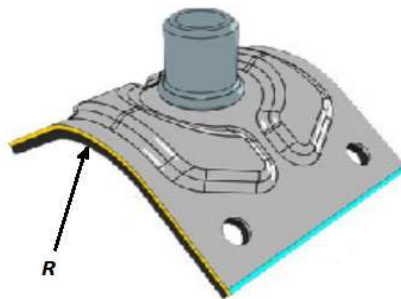
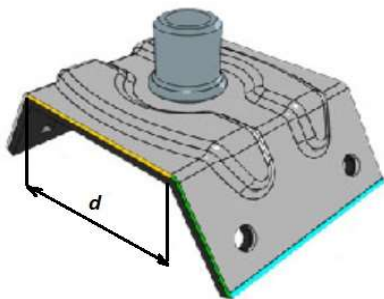

DTS 609

d (mm)	β	KAL
25	27°	o
32	35°	o
36	40°	o
41	32°	o
54	32°	o
26	15°	o
26	50°	o
45	17°	o

DTS 609 S

R (mm)	KAL
24	o
48	o

