

HRN
DIN 7337
ISO 15983
UNI 9200

Blok zakovica
Flachrun Blindniete
Open end rivets dome head
Rivetti a strappo a testa bombata

FE
AL
AL / RAL
FE / RAL
CU
A2
A4

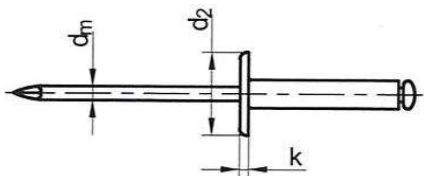

FE / FE

	Ø3,2	Ø4,0	Ø4,8
d₂	6.5	8	9.5
d_m	2	2.45	2.95
k	1	1.2	1.3
SVRDLO	3.3	4.1	4.9

CU

	Ø3,0	Ø3,2	Ø4,0
d₂	6.5	6.5	8
d_m	2	2	2.45
k	1	1	1.2
SVRDLO	3.1	3.3	4.1

A2-INOX

	Ø3,2	Ø4,0
d₂	6.5	6.5
d_m	2	2
k	1	1
SVRDLO	3.1	3.3

L \ D	Ø3,2	Ø4,0	Ø4,8
6	o	o	
8	o	o	o
10	o	o	o
12	o	o	o
14		o	o
16		o	o
18		o	o
20		o	o

L \ D	Ø3,0	Ø3,2	Ø4,0
4	o		
6	o	o	o
7		o	
8	o	o	o
9		o	o
10	o	o	o
11	o	o	o
12	o		o

L \ D	Ø3,2	Ø4,0
6	o	
7	o	o
8	o	o
9	o	o
10	o	o
11	o	o
12	o	o

AL / FE

	Ø3,2	Ø4,0	Ø4,8
d₂	6.5	8	9.5
d_m	2	2.45	2.95
k	1	1.2	1.3
SVRDLO	3.3	4.1	4.9

AL / FE - RAL

	Ø3,2	Ø4,0
d₂	6.5	8
d_m	2	2.45
k	1	1.2
SVRDLO	3.3	4.1

L \ D	Ø3,2	Ø4,0	Ø4,8
6	o	o	o
8	o	o	o
10	o	o	o
12	o	o	o
14	o	o	o
16	o	o	o
18		o	o
20		o	o

L \ D	Ø3,2	Ø4,0
6	o	
8	o	
10	o	o